

DATA SHEET SERVO MOTOR

LAFERT B28 D4

3 phase synchronous servo motor
 High-grade 8 pole brushless with integrated
 encoder. Metal plug full shielded.
 Optional: Shaft key / Internal break

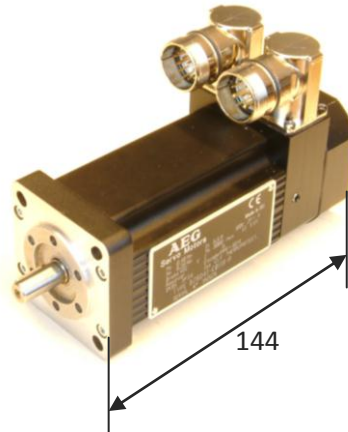

Pin Connections

Encoder Hall	
Sinal	Pin connections
Gnd	1
5V	2
Enc A	3
Enc A*	4
Enc B	5
Enc B*	6
Enc Z	7
Enc Z*	8
Hall U	9
Hall U*	10
Hall V	11
Hall V*	12
Hall W	13
Hall W*	14

Motor	
Signal	Pin connections
Phase U	4
Phase V	6
Phase W	8
Thermo	1
Thermo	2
Break +24V	3
Break 0V	5

Motor Data LAFERT B28 D4

Nn	3000 U/min
Nmax	6000 U/min
In	6.6A
Ip	23 A
Mn	0.38 Nm
Mpeak	1.4 Nm
Torque constant	0,061 Nm / A
EMF	11V / 3000 U/min
Inertia	$0.127 \cdot 10^{-4} \text{ kgm}^2$
Resistance coil	0,354 Ohm
Inductance coil	0,499 mH
Enc Inc. / U	1024
A/ B/ Z Signal	RS 422

**Dimension,
shaft key optional**

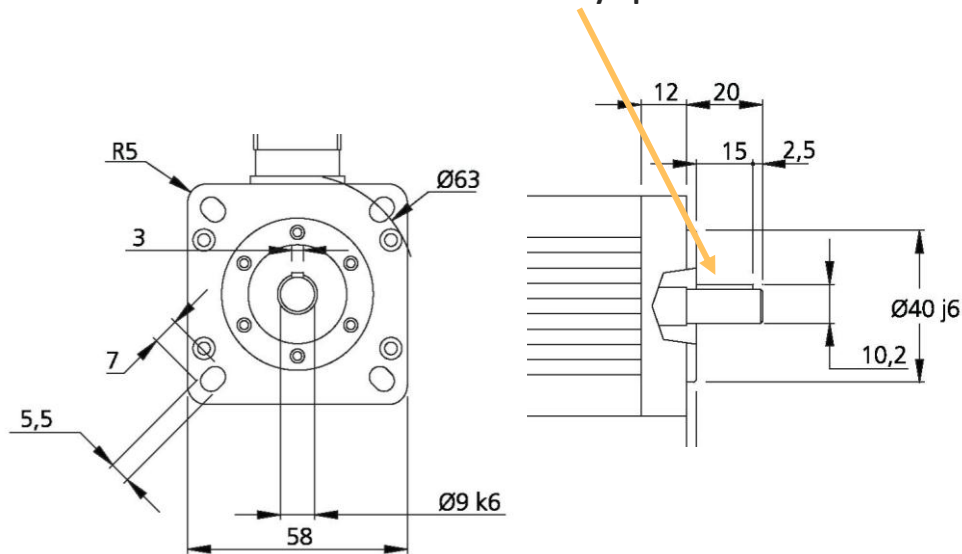

Recommended Servo Controllers

- XENAX® Xvi 75V8
- XENAX® Xv 50V6
- XENAX® Xvo 50V5
- Sv 72V10 AC

Servo Motor with Key Way and Break

The servo motor with key way and brake is only available with the XENAX® Xvi 75V8. Additionally a special cable is needed for servo motors including brakes.

The brake is wired on output 1 of the 26 pole D-Sub connector.

Please also program following settings in the WebMotion® user interface:

Brake Output 1
(under *application / i/o*)

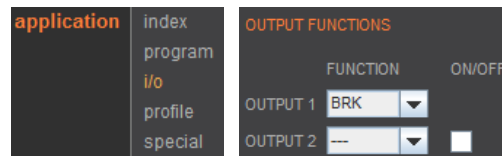

„SOT 21844“ and „SOA 254“ have to be set
(under *move axis/by command*)

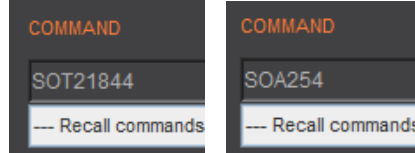
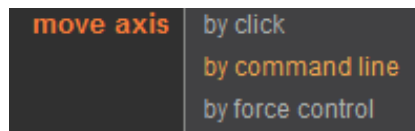

SERVOMOT_LAFERT_E.doc/ 25.06.2014 / OWA

Jenny Science AG
Sandblatte 7a
CH-6026 Rain, Schweiz

Tel +41 (0) 41 455 44 55
Fax +41 (0) 41 455 44 50

www.jennyscience.ch
info@jennyscience.ch

© Copyright Jenny Science AG 2014